

# Retail at UCSF Minnesota Housing San Francisco, California



## Location

Located at 602 Minnesota Street on the ground floor of UCSF Student and Trainee Housing (opening June 2019)

## Space Available

5,140 square feet (includes retail mechanical space) for a community focused “Corner Market” concept with groceries, convenience items, prepared packaged foods/deli items, coffee and espresso drinks, and wine/beer.

*Schematic layout is available on our website.*  
<http://campuslifeservices.ucsf.edu/retail/services/lease>



## Area Highlights

- One block from the UCSF Medical Center at Mission Bay
- Two blocks from the UCSF Mission Bay campus and biotechnology hub, where academic and industry came together for cutting-edge life-saving research
- On the ground floor of UCSF Housing for 750 graduate students and trainees
- Next door to the UCSF 654 Minnesota Street building where 250 UCSF staff work, adjacent to Esprit Park, and a community jewel
- Five-minute walk to the SF MUNI T-Third St. line and 55-16th St. bus line
- AT&T Park, Mission Creek, Bay Front Park, Caltrain are within a one-mile radius
- Future home of the Golden State Warriors, the Chase Center, within one half-mile radius
- Adjacent to other new housing developments in Dogpatch. Over 2300 new housing units proposed in the next 5 years.

## Contact Us

### Jen Dowd, Retail Services

University of California, San Francisco  
1675 Owens St. Box 3025,  
San Francisco, CA 94143  
Phone: 415.514.4743  
E-mail: [retail.services@ucsf.edu](mailto:retail.services@ucsf.edu)

**Please utilize the proposal template  
available on our website.**

## Retail at UCSF Minnesota Street Housing

### A City Within a City

#### About UCSF - Facts & Figures

In 2003, UC San Francisco opened its 43-acre Mission Bay Campus just north of Potrero Hill and Dogpatch. UCSF Mission Bay, the largest biomedical university expansion in the country, doubled UCSF's research space and sped the pace of biomedical discovery. With an ever-growing population, the Mission Bay Campus currently houses over 9,400 UCSF faculty, staff, students, patients, and visitors. With a workforce of over 24,000 people, UCSF is San Francisco's second largest employer. Rising from San Francisco's waterfront and just south of Mission Bay are Potrero Hill and Dogpatch, two neighborhoods that are steadily gaining notoriety for their restaurant scenes, unique shops, breweries, and more. Potrero Hill and Dogpatch offer stunning views of the city's skyline and bay views and a relaxed yet casual feel for laid-back locals and friendly visitors alike. UCSF understands the impact it can have on neighboring communities and is proud of the partnerships it has formed with neighborhood associations to respond to this dynamic growth.



**Over 9000 people visit and work at the Mission Bay campus daily**

#### About the Customers at UCSF

- Cost-sensitive
- Diverse cultural backgrounds
- Faculty, staff, graduate students, and post-doctoral fellows
- Researchers and medical practitioners
- Medical center patients and visitors
- Long-term UCSF staff
- Expect high-quality goods and services
- Highly educated with a sophisticated palate

***Customer Survey and Focus Group Report specific to "Corner Market" available on our website.***





## Retail at UCSF Minnesota Street Housing

### Site Map

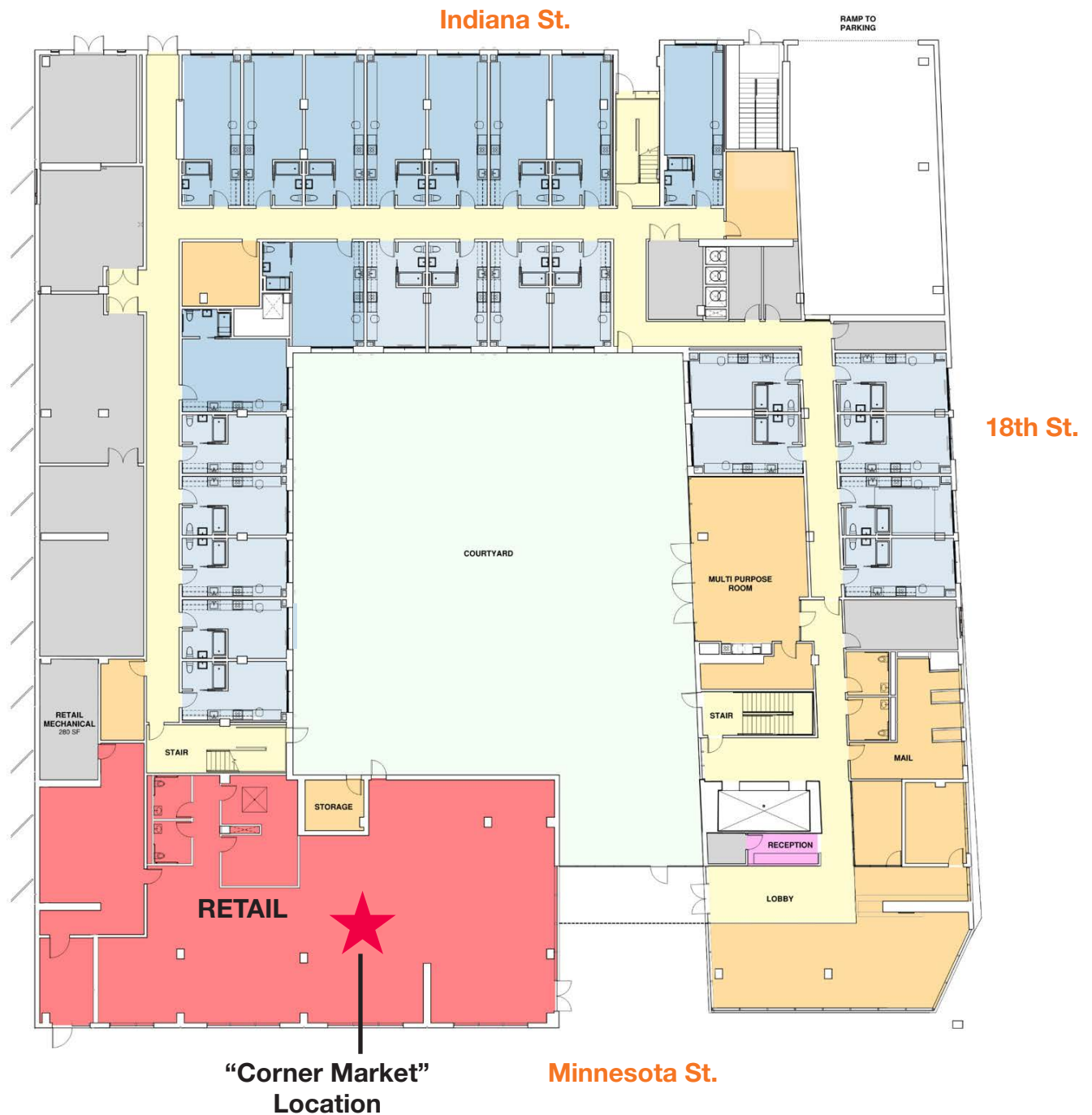





## Retail at UCSF Mission Bay Housing

### Campus Map



DEMOGRAPHICS			
	1 MILE	3 MILES	5 MILES
2017 Estimated Population	34,870	451,228	690,599
Growth 2017-2022	1.93%	1.21%	1.08%
2017 Est. Avg. Household Income	\$171,435	\$122,241	\$125,948

\*Source: CBRE Research 2017

**2017**  
GOLDEN STATE WARRIORS  
San Francisco Arena Development Project  
Opening in 2019