



Retail at UCSF Millberry Union Food Court San Francisco, California



Location

The retail space is located at the UCSF Parnassus Heights Campus, 500 Parnassus Avenue on Floor 1 of Millberry Union. Millberry Union is a multi-use building with administrative offices, patient care clinics, pharmacy, a credit union branch, food service outlets, ATMs, and the Millberry Union Fitness and Recreation Center.

Space Available

The retail space is 770 square feet. The desired food concept is Asian quick service. The location is in a food court collocated with Cafe Bellini and Carmelina's Taqueria



Area Highlights

- Directly across the street from UCSF Medical Center, and the Medical Sciences Building.
- In the center of the Parnassus Heights Campus and a five-minute walk from most facilities on campus.
- Adjacent to both the public and staff parking garages.
- Within a block of UCSF shuttle system and SF MUNI bus stops.
- Five-minute walk to the SF MUNI N-Judah light rail line on Irving Street.

Contact Us

Jen Dowd, Retail Services
University of California, San Francisco
1675 Owens St. Box 3025
San Francisco, CA 94143
Phone: 415.514.4743
E-mail: retail.services@ucsf.edu

**Letter of Interest due by:
November 17, 2017**

Over 16,000 people visit and work at the Parnassus Heights campus daily.

DEMOGRAPHICS			
	1 MILE	3 MILES	5 MILES
2017 Estimated Population	55,775	579,679	921,024
Growth 2017-2022	0.82%	0.97%	1.02%
2017 Est. Avg. Household Income	\$147,319	\$126,686	\$122,523
Source: CBRE Research 2017			



Retail at UCSF Millberry Union Food Court

A City Within a City

About UCSF's Parnassus Heights Campus

Parnassus Heights is UCSF's vibrant campus in the inner Sunset mixed-use neighborhood at the base of Mount Sutro. It is the oldest and largest campus site belonging to UCSF. It comprises approximately 107 acres of land and about 3.29 million gross square feet of building space. The Parnassus Heights campus is home to UCSF's classroom instruction, the four schools (Dentistry, Medicine, Nursing, and Pharmacy), adult inpatient facilities, a variety of outpatient clinics, research, housing, and support uses. The physical core of the campus is on Parnassus Avenue where those clinical, research, instructional, and support uses interface.

Approximately 80 percent of UCSF's 4,760 students and clinical residents are educated at Parnassus Heights, and more than 8,300 UCSF faculty and staff are employed there. UCSF provides housing for over 560 individuals at Parnassus Heights, a number that is anticipated to grow in the future. More than 256,000 outpatient visits per year occur at clinics on Parnassus Heights. With a workforce of over 22,300 people, UCSF is San Francisco's second largest employer.



Over 16,000 people visit and work at the Parnassus campus daily

About the Customers at UCSF

- **Cost-sensitive**
- **Diverse cultural backgrounds**
- **Faculty, staff, graduate students, and post-doctoral fellows**
- **Researchers and medical practitioners**
- **Medical center patients and visitors**
- **Long-term UCSF staff**
- **Expect high-quality goods and services**
- **Highly educated with a sophisticated palate**

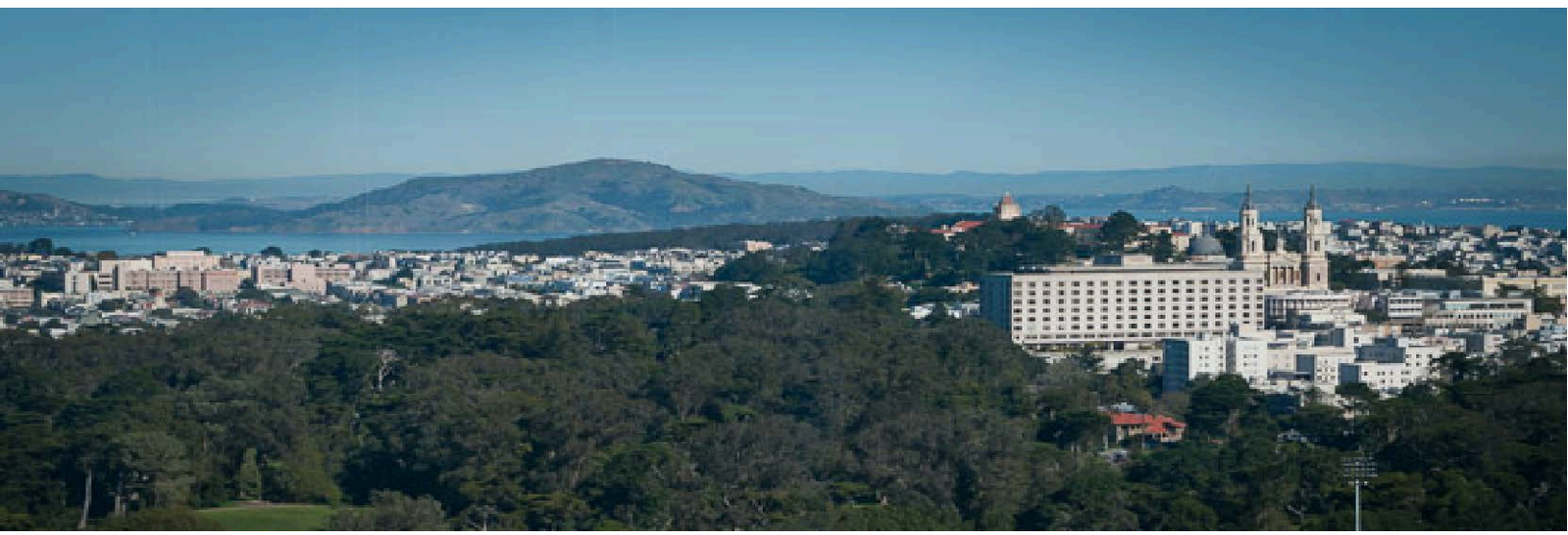



Retail at UCSF Millberry Union Food Court

Site Map of 500 Parnassus Ave. Floor 1

★ = Retail Location

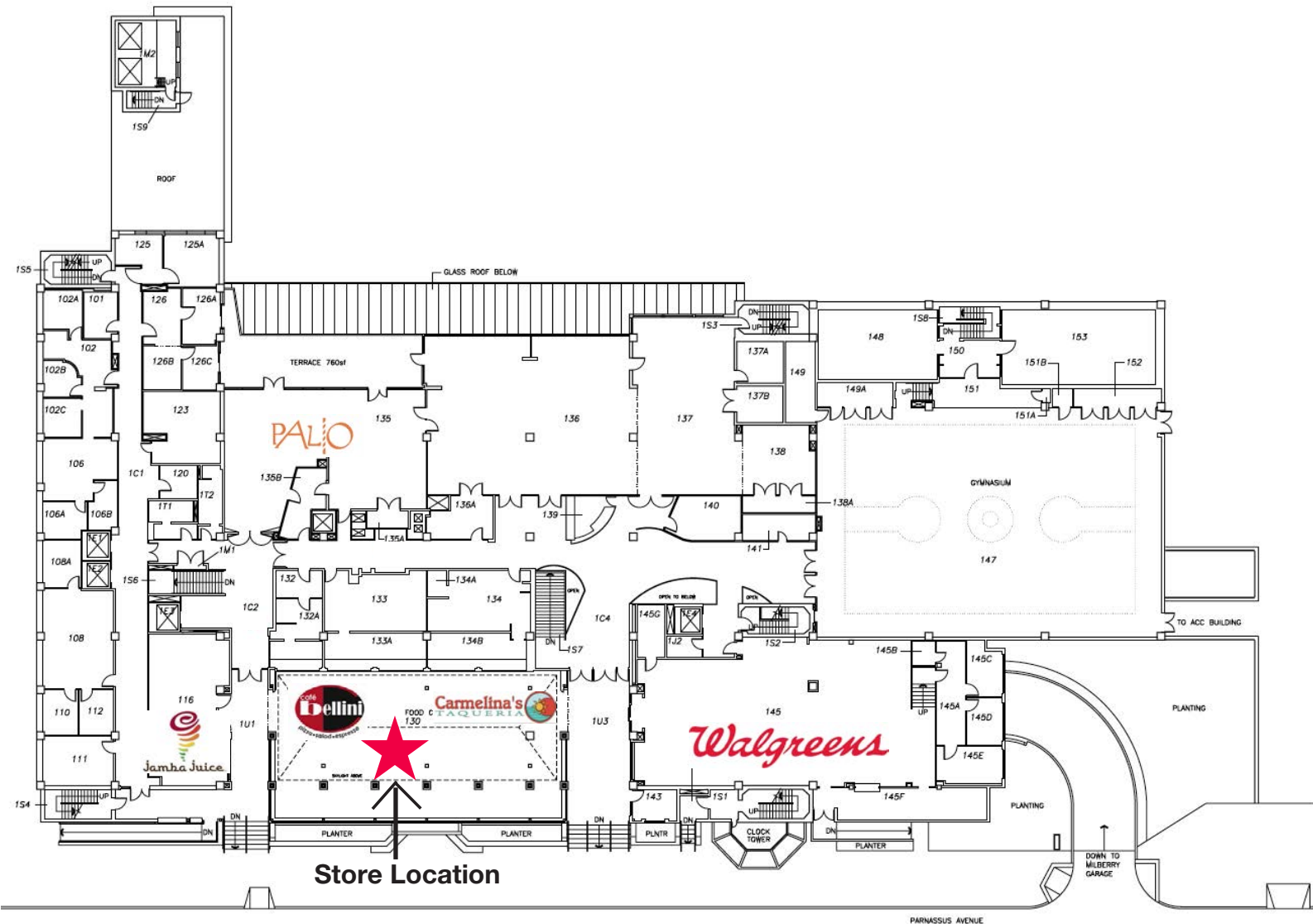

Store Location

Parnassus Avenue



Retail at UCSF Millberry Union Food Court

Campus Map

★ = Retail Location

